



THIS JUST IN: The Lower Elementary Program expanding for the 2024-2025 school year

Due to our unprecedented anticipated retention for the 2024-2025 school year, the decision has been made to expand the Lower Elementary program to meet the high demand. With full enrollment in the current configuration of the main building this year, Summit will be reconfiguring spaces over the summer to allow for a larger Lower Elementary program. This expansion may well serve as a stepping stone towards two Lower Elementary classrooms in the not so distant future. The Lower Elementary expansion will also have implications for the Children's House program as classrooms will by necessity shift spaces within the main building.

The Children's House 2 classroom will be moved to the first floor to inhabit the current Marino Room and the Head of School's office with an expanded opening between the two rooms. The current Children's House 2 classroom will be used as an additional space for the Lower Elementary students and connected to the current Lower Elementary classroom through a large opening between the rooms. A third full-time Montessori lead teacher will be hired in Lower Elementary, increasing the collective wisdom base for that level. There will also be smaller logistical changes creating space for a new Head of School's office, meeting spaces for administrative staff, and work space for classroom teachers.

We are thrilled to be moving into this next phase of expansion for our school and the possibilities it brings. Summit is creating a brighter, more expansive future for all of our incredible students who walk through our doors. Here's to growth, learning, and endless possibilities!

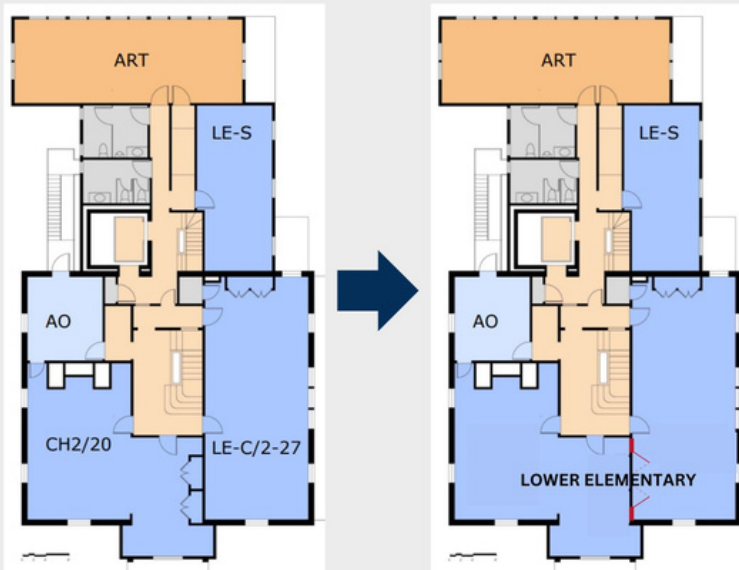

**Second
Floor
Changes**

SAVE THE DATE!

APRIL 6 – The Magic of Summit:
The Annual Spring Event and
Auction

MAY 9 – Night of the Arts

Upper Elementary and Children's House Provide the Entertainment During this Holiday Season



On the evening of December 14th, families gathered in our new Community Room to watch the Upper El class perform William Shakespeare's "The Tempest."

The class spent weeks preparing for this evening. They researched Shakespeare and collectively wrote an essay about his life. They created the extensive sets and elaborate costumes in Art Class with Ms. Catherine. They memorized their lines and practiced, practiced, and practiced some more. They wrote about the process. They performed abridged versions of their show for the Children's House classes and ran a full dress rehearsal in front of the Lower El. class. When it was time for the big show, they were more than ready.

The show was a joy to watch. The students were amazing: fresh, funny, completely engaged, happily experimenting outside of their comfort zones, and downright entertaining. Huge kudos to the Upper Elementary team, led by Lead Teacher Hannah Army and supported by Sharlow Hitchcock, David Mingolla, Katie Tremblay, our Art Teacher Catherine Byrne, and our Elementary Music Teacher Laura Murray, for guiding our students through each step of the complex process necessary to bring the play from script fruition. Needless to say, the audience roared its appreciation, and our young thespians emerged triumphant!

Children's House Holiday Concert

On the final day before our community left for Winter Break, the Children's House classes performed their annual Holiday Show. Ms. Jackie led the students as they sang "Feliz Navidad," "Jingle Bells," "Better Bundle Up," "Peppermint Stick," and "Light a Candle for Peace."





An Evening With Summit Friends

On a frigid January night, current and former board members, administrators, faculty, current and former parents, and friends of the school came together at the home of one of our board members to celebrate and appreciate the many manifestations of leadership at Summit. The work of past and current boards, SMPA leaders, and leadership donors have propelled the school to its highest enrollment yet and a strong financial position for the future. Summer Shaud, our host, a board member, and a parent of two children at Summit, welcomed everyone and spoke of her inspiration to serve. Matt Grasse, Board Chair and parent of two Summit students, expressed his excitement at leading such an inspiring group. Rebecca Crawford, Director of Advancement, announced our Lower Elementary Expansion project followed by Jessica Milan, board member and parent of a Summit student, who led the group in expressing gratitude for the various constituencies of the school and the work that they've put in to make Summit the place it is today.



Staffing Updates

There are some exciting staffing changes that have taken place this year.

Patrick Francois, who has worked as a much-loved After Care and classroom Support Teacher for about two years, has taken on the increased responsibility of serving as our After Care Director. Patrick is energetic, creative, and an amazing early childhood teacher and program designer.

Patrick earned a B.A. in Interdisciplinary Studies (with concentrations in Child Psychology, Children's Literature, and Middle School Education) at Fitchburg State University. He holds multiple EEC certifications and prior to his work at Summit, Patrick had 12 years of early childhood teaching and program direction experience in a variety of settings in Boston and Cambridge.

We are also thrilled to welcome Lise Lorimer as the new Assistant Teacher in the Beginners 1 classroom. Lise is the mother of two Summit students, and she brings an impressive background in teaching as a horticulturalist, garden educator, and farm manager. Lise has served as a substitute teacher and lunch support teacher at Summit for the past year. She earned a BFA in Dance and Choreography from the University of North Carolina at Greensboro and started her Montessori training at the Westside Montessori Teacher Education Program.

Welcome Lise and congratulations to Patrick!